



Test Report **No.:** **68.190.20.0071.01-00**
Dated: **2020-01-15**

Applicant: Golden Sailing Co., Ltd
Address: B1005, Floor 10, Tiangong Int'l Security Electronics Square, Longhua Dist.,
Shenzhen, China
Sample Submission: The sample was submitted by applicant and identified.
Product Name: Aluminium Stage
Order No.: ----
Identification/Style No.: GS-ST01; GS-ST04
Manufacturer: Golden Sailing Co., Ltd
Country of Origin: China
Buyer: ----
Export to: ----
Receipt Date of Sample: 2020-01-02
Date of Testing: From 2020-01-02
Test Result: Refer to the data listed in following pages

Test Specification(s) or Test Item(s):

1. **Loading test according to customer's request**

Hardline Laboratory

TÜV SÜD Certification and Testing (China) Co., Ltd
Shenzhen Branch

Tested By: _____

Leo Lu
Leo Lu
Test Engineer



Reviewed By: _____

James Huang
James Huang
Project Manager

Note: (1) "General Terms & Conditions" applied. For full version, please visit: <http://www.tuv-sud.cn/cn-scn/terms-and-conditions>
2) Any use for advertising purposes must be granted in writing. This technical report may only be quoted in full. This report is the result of a single examination of the object in question and is not generally applicable evaluation of the quality of other products in regular production. For further details, please see testing and certification regulation, chapter A-3.4. 3) The conclusion of test result was drawn according to corresponding regulation or standard method and/ or client's requirement

Laboratory:
No.11, Jukeng Rd., Juling Village, Jutang
District, Guanlan, Longhua New District,
Shenzhen, 518110, P.R.China

Telephone : +86 755 8828 6998
Telefax : +86 755 8828 5299
<http://www.tuv-sud.cn>

Regd. Office:
TÜV SÜD Certification and Testing (China) Co.,
Ltd. Shenzhen Branch, TÜV SÜD Group
Building 12 & 13, Zhiheng Wisdomland Business
Park, Nantou Checkpoint Road 2, Nanshan
District, Shenzhen 510656, P.R. China

Page 1 of 4

1 Description of the test subject

1.1 Function

Manufacturer's specification for intended use: not specified.

1.2 Consideration of the foreseeable misuse

Not applicable

1.3 Technical Data

Product :	Aluminium Stage GS-ST01; GS-ST04
Overall Dimension :	1,22 m x 1,22 m
Top surface(mm) :	Laminated wood T18,0 mm

2 Order

2.1 Date of Purchase Order, Customer's Reference

2019-11-26

2.2 Receipt of Test Sample, Location

/

2.3 Location of Testing

104. No.17, Xinhuan Middle Road, Xinqiao Village ,Dalong street , Panyu District , Guangzhou , China

2.4 Points of Non-compliance or Exceptions of the Test Procedure

None

3 Test indication

3.1 Construction inspection – Comparison of the test sample to the drawings of the underlying documentation

A comparison has shown that the test sample is confirming to the drawings of the underlying documentation.

3.2 Load test

The nominal loads were applied and the deflections were measured.

Uniformly distributed load (UDL)

The stage was supported by four poles at four ends.
A specified nominal load was uniformly distributed according to Figure 1. on the stage and the deflection under this loading condition was measured accordingly.

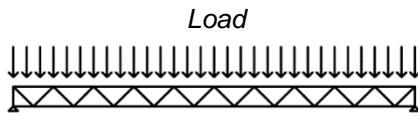

Figure 1

4 Test result

Measured deflection, (mm) – Deflection under load
 Residual deflection,(mm) – Deflection after the load is removed

4.1 Test Results

Nominal load test

Item	GS-ST01	GS-ST04
Surface Area, (m ²)	1,22 x 1,22	
Total load applied, (kg)	750	
Measured deflection, (mm)	5	4
Residual deflection,(mm)	2	1
Test results	No visible damage was found after test.	

5 Documentation

TESTING PHOTO



GS-ST01



GS-ST04

Remark:

1. The sample has been examined according to the minimum requirements described in the product standard.
2. This report's data derived from test report No.68.190.19.0900.01, issued on date: 2020-01-10,

The followings have changed according to applicant's request:

- 1). Change of applicant's name and address.
- 2). Change of models name.

-End of Test Report-